



DERE STREET  
*Homes*

# The Middleham

Four bedroom family home

The Middleham is a well-designed four-bedroom family home. The spacious, dual aspect living room sweeps the entire length of the home, with a door opening out onto the rear garden, adding to its light and airy feel. The open plan family room, kitchen and dining area is ideal for a busy household to eat, cook and relax together with a single door leading out into the garden allowing plenty of light.

The turned staircase leads to four generous bedrooms and a family bathroom. The master bedroom benefits from an En-Suite and a generous space ideal for dressing room or a walk-in wardrobe.



## Specifications

- Dual aspect living room with door leading out to rear garden
- Spacious kitchen/dining area and family room
- Master bedroom with En-Suite and space ideal for walk in wardrobes
- Four generous bedrooms
- Single detached garage

Be inspired at [www.derestreethomes.co.uk](http://www.derestreethomes.co.uk)

# The Middleham

Four bedroom family home

## Floor Plans & Dimensions

Ground Floor



First Floor

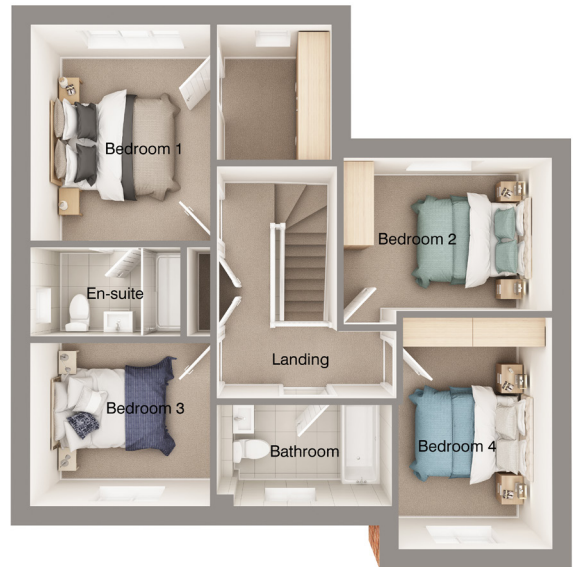

Ground Floor

Room	MM	FT
Living Room	3448 x 6590	11'3" x 21'6"
Kitchen/Dining	2877 x 8115	9'4" x 26'6"

First Floor

Room	MM	FT
Bedroom 1	3027 x 3647	9'9" x 11'9"
Bedroom 2	2582 x 3510	8'4" x 11'5"
Bedroom 3	2742 x 3027	9'0" x 9'9"
Bedroom 4	2584 x 3894	8'4" x 12'7"

Principal dimensions are not measured into areas including (but not restricted to) bay windows, alcoves or wardrobes where applicable. The dimensions where specified are for indicative purposes only and are not intended to be relied upon for determining (without limitation) carpet sizes, appliances, spaces or items of furniture. The company's policy is one of continuous product development and improvement, both in design and in construction. We therefore reserve the right to make amendments without notice. The illustration and particulars set out above are for illustration purposes and general guidance only since items such as (without limitation) brick and tile colour, door styles and external treatments including landscaping may vary from time to time. Please ask for details of the treatments specified for individual plots. These particulars cannot be relied upon as accurately describing any of the prescribed matters specified in any order made under the Property Misdescriptions Act 1991 nor do they constitute a contract, part of a contract or a warranty. January 2014.

**CONSUMER  
CODE FOR  
HOME BUILDERS**

[www.consumercode.co.uk](http://www.consumercode.co.uk)